

PERMIT  
 CITY OF NAPOLEON, OHIO - BUILDING DEPARTMENT  
 255 West Riverview Avenue, Napoleon, Ohio 43545 - (419) 592-4010

Permit No. <u>3770</u>	Issued <u>01/23/96</u>		FEES	BASE	PLUS	TOTAL
Job Location <u>1115 Westmont Ave.</u>	<input checked="" type="checkbox"/> Building	\$ <u>9.00</u>	\$ <u>274.00</u>	\$ <u>283.00</u>		
Lot <u>34</u> <u>Gerken/Hoeffel Third</u>	<input checked="" type="checkbox"/> Electrical	\$ <u>15.00</u>	\$ <u>84.00</u>	\$ <u>99.00</u>		
Issued by <u>Brent N. Damman</u>	<input checked="" type="checkbox"/> Plumbing	\$ <u>9.00</u>	\$ <u>39.00</u>	\$ <u>48.00</u>		
Owner <u>Cathy Higbea 592-5636</u>	<input checked="" type="checkbox"/> Mechanical	\$ <u>18.00</u>	\$ <u>16.00</u>	\$ <u>34.00</u>		
Address <u>1449 Ohio Napoleon, Ohio</u>	<input type="checkbox"/> Demolition	\$ _____	\$ _____	\$ _____		
Agent <u>Mock/Buehrer 592-3626</u>	<input type="checkbox"/> Zoning	\$ _____	\$ _____	\$ _____		
Address <u>145 Capri Napoleon, OH</u>	<input type="checkbox"/> Sign	\$ _____	\$ _____	\$ _____		
Use Type - Residential <u>X</u>	<input checked="" type="checkbox"/> Water Tap	\$ <u>650.00</u>	\$ _____	\$ <u>650.00</u>		
Other - Describe _____	<input type="checkbox"/> Sew. Insp.	\$ _____	\$ _____	\$ _____		
No. Dwelling Units _____	<input checked="" type="checkbox"/> Sewer Tap	\$ <u>60.00</u>	\$ <u>123.00</u>	\$ <u>183.00</u>		
New <u>X</u> Replacement _____	<input checked="" type="checkbox"/> Temp. Water	\$ <u>5.00</u>	\$ _____	\$ <u>5.00</u>		
Add'n. <u>Alter</u> <u>Remodel</u>	<input type="checkbox"/> Temp. Elec.	\$ <u>10.00</u>	\$ _____	\$ <u>10.00</u>		
Change of Occupancy _____	TOTAL FEES.....\$ <u>1312.00</u>					
Estimated Cost \$ <u>152,000.00</u>	LESS FEES PAID.....\$ _____					
	BALANCE DUE.....\$ _____					

ZONING INFORMATION

district	lot dimensions	area	front yd	side yd	rear yd
R-2	85 x 20	10,200	30	10	
max hgt	no pkg spaces	no ldg spaces	max cover	petition or appeal req'd	date appr

WORK INFORMATION

Size: Length 66' 8" Width 60' 8" Stories 2 Ground Floor Area 2831  
 Height \_\_\_\_\_ Building Volume (for Demo. Permit) \_\_\_\_\_  
 Electrical: \_\_\_\_\_  
 Plumbing: \_\_\_\_\_  
 Mechanical: \_\_\_\_\_  
 Additional Information: New Home  
 Date \_\_\_\_\_ Applicant Signature \_\_\_\_\_



METER SOCKET RELEASE

issued by

The Napoleon Electric Distribution Department  
639 Industrial Drive Napoleon, Ohio 43545 Pn. 592-9116 or 592-4010

Permit No. E- 2:8 Issued 3-25-96 Building permit No. 3770 Job Address 1115 Westmont

Lot Number 34 Sub Division Geerken / Horffel Third

Owner Cathy Higbee Owners Address 1449 Ohio Nap Pn. No. 592-5636

Contractor Mark / Buchner Contractors Address 145 Capri Pn. No. 592-3626

Size of Service 200 Overhead  Underground  Issued By Brent Dammann

In City  Outside City

Date completed \_\_\_\_\_ Approved by \_\_\_\_\_

Size of Service \_\_\_\_\_ Overhead  Underground  Street and No. \_\_\_\_\_ electric distribution dept.

Old Meter No. \_\_\_\_\_ New Meter No. \_\_\_\_\_ Remarks \_\_\_\_\_

Sketch of Service







**APPLICATION FOR**

Residential, Building, Electrical, Plumbing, Mechanical, and Demolition Permit

FROM - The City of Napoleon, Ohio, Building Department

255 West Riverview Avenue; P.O. Box 151; Napoleon, Ohio 43545 - Telephone (419) 592-4010

ENTRY NO. \_\_\_\_\_

PERMIT NO. 3770 ISSUED 1-23-96

JOB LOCATION 1115 Westmont

LOT 34 Lenox Heights Third  
(Subdivision or Legal Description)

ISSUED BY BMD  
(Building Official)

OWNER Cathy Higley PHONE 592-5636

ADDRESS 1449 Ohio Nap.

AGENT Mark Bushnell PHONE 592-3626

ADDRESS 145 Capri Nap.

USE:  Residential ( ) Commercial ( ) Industrial  
( ) Other \_\_\_\_\_

WORK:  New ( ) Addition ( ) Replacement ( ) Remodel

ESTIMATED COST = \$ 152,000.00

	<u>(X) Building</u>	\$ <u>9.00</u>	\$ <u>274.00</u>	\$ <u>283.00</u>
	<u>(X) Electrical</u>	\$ <u>15.00</u>	\$ <u>84.00</u>	\$ <u>99.00</u>
	<u>(X) Plumbing</u>	\$ <u>9.00</u>	\$ <u>39.00</u>	\$ <u>48.00</u>
	<u>(X) Mechanical</u>	\$ <u>18.00</u>	\$ <u>16.00</u>	\$ <u>34.00</u>
	( ) Demolition	\$ _____	\$ _____	\$ _____
	( ) Zoning	\$ _____	\$ _____	\$ _____
	( ) Sign	\$ _____	\$ _____	\$ _____
	<u>(X) Water Tap</u>	\$ <u>650.00</u>	\$ _____	\$ <u>650.00</u>
	<u>(X) Sewer Tap</u>	\$ <u>60.00</u>	\$ <u>123.00</u>	\$ <u>183.00</u>
	<u>(X) Temp Water</u>	\$ <u>5.00</u>	\$ _____	\$ <u>5.00</u>
	<u>(X) Temp Elec.</u>	\$ <u>10.00</u>	\$ _____	\$ <u>10.00</u>

Additional Structure \_\_\_\_\_ Hours \_\_\_\_\_  
Plan Review: Electric \_\_\_\_\_ Hours \_\_\_\_\_

TOTAL FEES . . . . . \$ 1312.00  
Less Fees Paid . . . . . \$ \_\_\_\_\_  
BALANCE DUE . . . . . \$ 1312.00

**ZONING INFORMATION**

District	Lot Dimensions	Area	Front Yard	Side Yard	Rear Yard
<u>R-2</u>	<u>85 x 120</u>	<u>10,200</u>	<u>30</u>	<u>10</u>	

Max Height	No. Pkg. Spaces	No. Ldg. Spaces	Max Cover	Petition or Appeal Required-Date

**WORK INFORMATION**

Building: Ground Floor Area 2831 sq. ft. Basement Floor Area 1261 sq. ft.

Garage Floor Area 612 sq. ft. 2nd Floor Area 210 sq. ft. Other Porch 56 sq. ft.

Size: Length 66'8" Width 60'8" Stories 2 Height \_\_\_\_\_

Building Volume (for Demolition Permit) \_\_\_\_\_ cubic feet

Description of Work: New Home:

**ELECTRICAL:** Contractor Tom Spruce Elec Phone \_\_\_\_\_  
Address \_\_\_\_\_ ESTIMATED COST = \$ \_\_\_\_\_  
**Type of Work:**  New  Service Change  Rewiring  Add'l Wiring TEMPORARY ELEC. REQUIRED -  Yes  No  
Size of Service 200 Underground  Overhead \_\_\_\_\_ Number of New Circuits 28

**Description of Work:** \_\_\_\_\_  
**PLUMBING:** Contractor \_\_\_\_\_ Phone \_\_\_\_\_  
Address \_\_\_\_\_ ESTIMATED COST = \$ \_\_\_\_\_  
WATER TAP REQUIRED -  Yes  No Size \_\_\_\_\_ Type of Pipe \_\_\_\_\_ Water Dist. Pipe \_\_\_\_\_  
SANITARY SEWER TAP REQUIRED -  Yes  No Size \_\_\_\_\_ Type of Pipe \_\_\_\_\_ Dr. Waste Vt. Pipe \_\_\_\_\_  
STREET SEWER TAP REQUIRED -  Yes  No Type of Pipe \_\_\_\_\_ STREET TO BE OPENED -  Yes  No  
Main Building Drain Size = \_\_\_\_\_ Main Vent Pipe Size = \_\_\_\_\_

**LIST NUMBER OF PLUMBING FIXTURES BELOW:**  
Water Closets = 2 Bathtubs = 2 Showers = \_\_\_\_\_ Lavatories = 4 Kitchen Sinks = 1 Disposal = 1  
Clothes Washer = 1 Floor Drains = \_\_\_\_\_ Dishwasher = 1 Other I.T. - 1 Total = 13

**Description of Work:** \_\_\_\_\_  
**MECHANICAL:** Contractor \_\_\_\_\_ Phone \_\_\_\_\_  
Address \_\_\_\_\_ ESTIMATED COST = \$ \_\_\_\_\_  
HEATING SYSTEM -  Forced Air  Gravity  Hot Water  Steam  Unit Heaters  Radiant  Baseboard  
TYPE OF FUEL -  Electric  Natural Gas  Propane  Wood  Coal  Solar  Geothermal Other \_\_\_\_\_  
NUMBER OF HEAT ZONES = 1 HOT WATER -  One (1) Pipe  Two (2) Pipes  Series Loop  
ELECTRIC HEAT - Number of Circuits \_\_\_\_\_ Number of Furnaces 1 Number of Hot Air Runs 17  
Number of Hot Water Radiators \_\_\_\_\_ Total Heat Loss \_\_\_\_\_ Rated Capacity of Furnace/Boiler \_\_\_\_\_  
LOCATION OF HEATING UNITS -  Crawl Space  Floor Level  Attic  Suspended  Roof  Outside

**Description of Work:** \_\_\_\_\_  
**DRAWINGS REQUIRED:** All applications must be accompanied by two (2) complete sets of Drawings including Site Plans, Foundation Plans, Floor Plans, Structural Framing Plans, Exterior Elevations, Section and Details, Stair Details, Electrical Layout, Plumbing Isometric, Heating Layout, etc. All Plans shall be drawn to scale, show all existing structure on the Site Plans, and show electric panel and furnace locations.

**READ AND SIGN BELOW:** The undersigned hereby makes application for a Permit for all work described herein and agrees to complete the work in strict accordance with all applicable provisions of the current edition of the C.A.B.O. Building Code, the Napoleon Building and Zoning Codes, the Napoleon Engineering Department Rules and Regulations, Standard Specifications and other pertinent sections of the Napoleon Code of Ordinances.

Signature of Applicant \_\_\_\_\_ Date \_\_\_\_\_

## METER YOKE RELEASE

This document is for the release of **one (1)** Water Meter Yoke for Residential water service lines.

RELEASE NO. 191  
PERMIT NO. 3770 ISSUED 3-25-96  
JOB LOCATION 1115 Westmont Ave.  
() - Inside City Limits ( ) - Outside City Limits  
ISSUED BY BND  
OWNER Cathy Higbee  
ADDRESS 1449 Ohio Map 592-5636  
CONTRACTOR Mock/Buehner  
ADDRESS 145 Capri Map Oh  
CONTRACTOR'S PHONE NO. 592-3626  
WATER TAP SIZE: () = 1" ( ) = 1-1/2" ( ) = 2"  
WATER METER s# \_\_\_\_\_  
() - New Dwelling ( ) - Existing Dwelling  
( ) - Lawn Meter

Water Service Line to be Type (K) Copper or (CTS) Polyethelene Tubing of one inch (1") minimum.

Watts No. 7 Dual check required ( ) = Yes () = No

Water Meter Yoke installation is subject to the following conditions:

- 1.) Must be located in an accessible area.
- 2.) Must be in an area not subject to freezing temperatures.
- 3.) Must be eighteen inches (18") above floor level, **not in crawl spaces.**
- 4.) Must comply with the mounting criteria and clearances as set forth in **DRAWING #04403901.**





WATER TAPPING PERMIT

issued by

The Napoleon Water Distribution Department

255 West Riverview Ave. Napoleon, Ohio 43545 Pn. 592-4010

Permit No. W-0131 Issued 3-25-96 Received of Mock/Buchner Const. (\$ 650 ) .00

(Charge for tapping permit to supply water service to) Lot No. 34 Sub Div. Gerken/Hoeffel 3rd

Street No. 1115 Westmont Tap Size 1" Cost \$ .00 Plumber Damman P & H

Date completed \_\_\_\_\_ Approved by [Signature] water distribution dept. finance director

Name \_\_\_\_\_ Size of tap 1" Date 4-3-96 Street and No. 1115 Westmont

Old Tap No. \_\_\_\_\_ New Tap No. 9622 Size and Kind of Main 8" C-900

Location of Main 8' South of South curb Depth of Main 5'

Distance from Hydrant/Valve 164' West of Hyd 211 Distance to Curb Stop from Corp. 10'

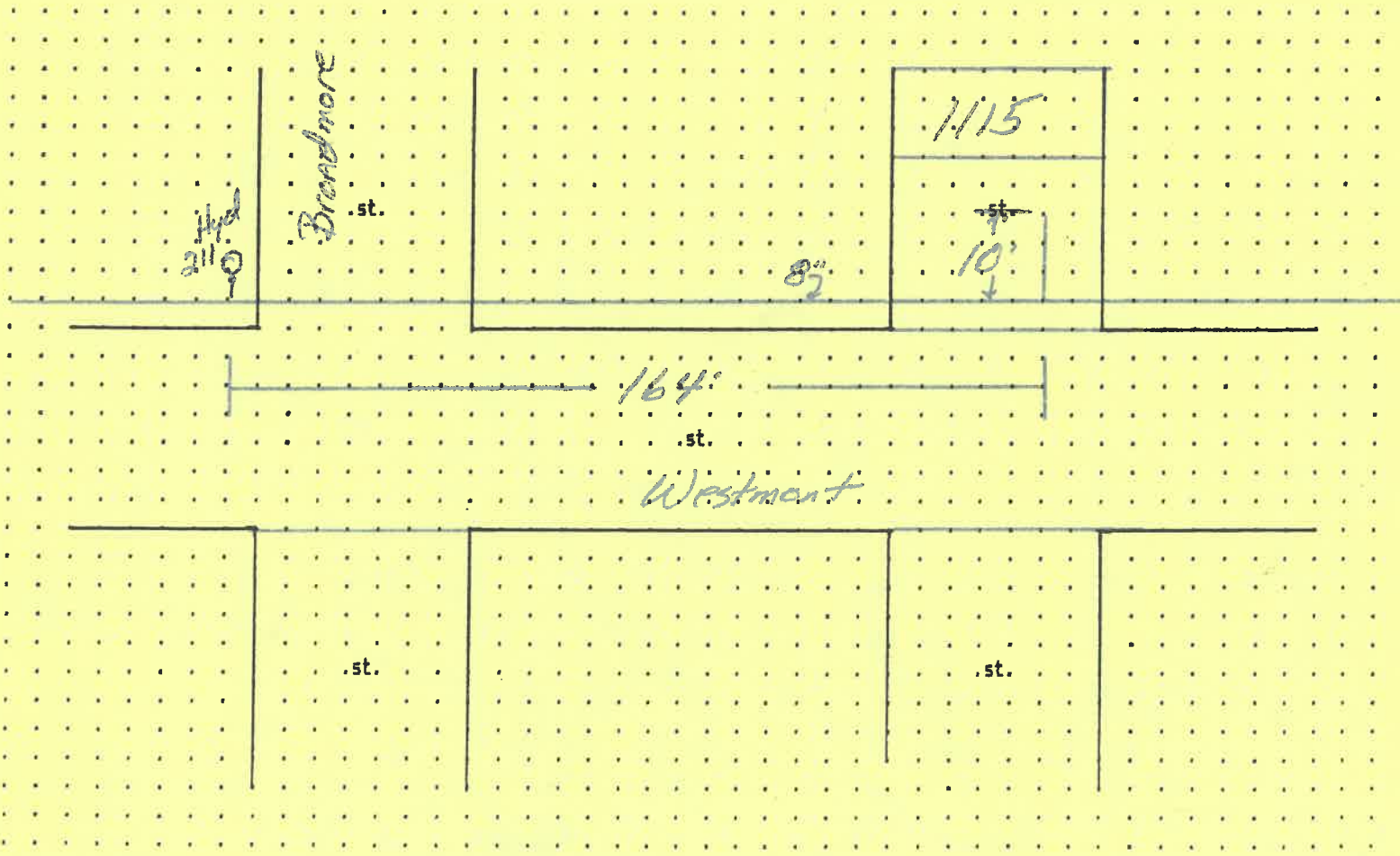



WATER TAPPING PERMIT

issued by

The Napoleon Water Distribution Department

255 West Riverview Ave. Napoleon, Ohio 43545 Pn. 592-4010

Permit No. W-0131 Issued 3-25-96 Received of Mack/Buchner Const. (\$ 650 ) .00

(Charge for tapping permit to supply water service to) Lot No. 34 Sub Div. Broken/Hoeffel 3rd

Street No. 1115 Westmont Tap Size 1" Cost \$ .00 Plumber Damman P+H

Date completed \_\_\_\_\_ Approved by [Signature] water distribution dept. \_\_\_\_\_ finance director

Name \_\_\_\_\_ Size of tap 1" Date 4-3-96 Street and No. 1115 Westmont

Old Tap No. \_\_\_\_\_ New Tap No. 9622 Size and Kind of Main 8" C-900

Location of Main 8' South of South CURB Depth of Main 5'

Distance from Hydrant/Valve 164' West of Hyd 211 Distance to Curb Stop from Corp. 10'

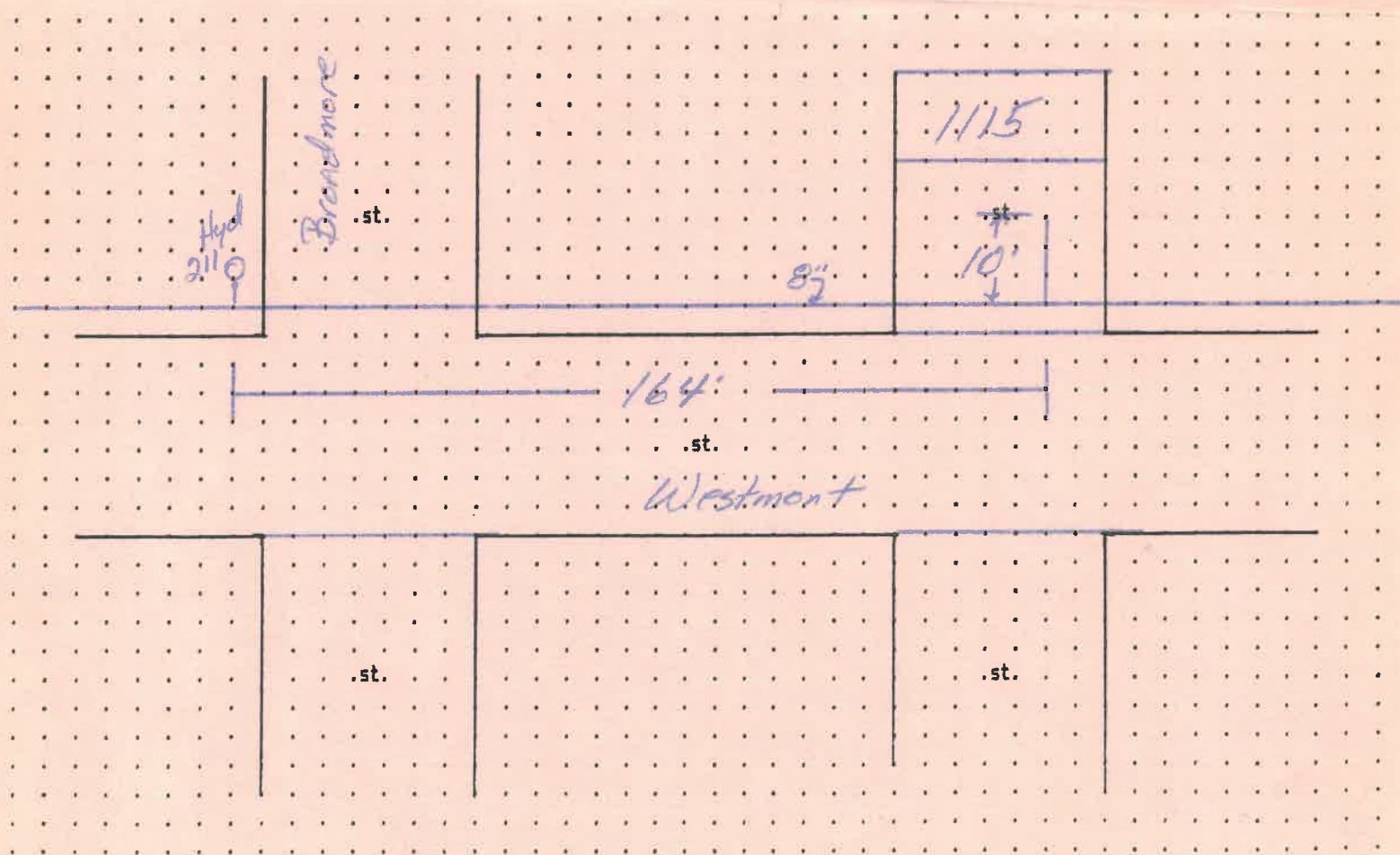





# METER YOKE RELEASE

This document is for the release of **one (1)** Water Meter Yoke for Residential water service lines.

RELEASE NO. 191

PERMIT NO. 3770 ISSUED 3-25-96

JOB LOCATION 111 Westmont Ave.

- Inside City Limits       - Outside City Limits

ISSUED BY BND

OWNER Cathy Higbee

ADDRESS 1449 Ohio Nap 592-5636

CONTRACTOR Mock/Burke

ADDRESS 145 Capri Nap Oh

CONTRACTOR'S PHONE NO. 592-3626

WATER TAP SIZE:  = 1"       = 1-1/2"       = 2"

WATER METER s# \_\_\_\_\_

- New Dwelling       - Existing Dwelling

- Lawn Meter

Water Service Line to be Type (K) Copper or (CTS) Polyethelene Tubing of one inch (1") minimum.

Watts No. 7 Dual check required  = Yes       = No

Water Meter Yoke installation is subject to the following conditions:

- 1.) Must be located in an accessible area.
- 2.) Must be in an area not subject to freezing temperatures.
- 3.) Must be eighteen inches (18") above floor level, **not in crawl spaces.**
- 4.) Must comply with the mounting criteria and clearances as set forth in **DRAWING #04403901.**





30' BUILDING SETBACK

N 0°46'00" W, 120.00'

LOT 33

N 88°41'00" E, 85.00'

17' CONC. DRIVE

9.16' 66.67'

PROPOSED HOME  
2,831 SQ.FT.

9.16'

29.39'

LOT 34

30"

60.67'

Storm from sump

4" PVC SDR35 @ 5.4' F.L.

S 88°41'00" W, 85.00'

No Scale

1115 Westmont

